

#### LOCATION

- Adjacent to National Institutes of Health (NIH) and Walter Reed National Military Medical Center (WRNMMC)
- In the heart of contemporary downtown Bethesda, MD
- One metro stop away from Washington DC
- Two miles from the Capital Beltway
- Four blocks from two metro stations
- Walking distance to over 150 shops and restaurants

#### EXECUTIVE MEETING CENTER & BANQUET FACILITIES

A purpose built, dedicated business environment. Certified by the International Association of Conference Centers. Ideal for grant reviews, training sessions and scientific programs. Features:

- Ergonomic chairs and glare-free meeting tables
- Individual climate controls in all meeting rooms
- Built-in LCDs and drop-down screens
- Enterprise-class high-speed Internet access
- Inclusive meeting package options with continuous refreshments at permanent break stations
- Five-station lunch buffet for all palates and dietary needs
- Business center access with workstations, color printing, copying and supplies to complete your presentation
- Eco-friendly facilities focused on recycling, energy and water conservation
- Allergy-free filtration system in all meeting rooms
- Stylish, spacious function space for weddings, Bar or Bat Mitzvahs and elegant events
- Innovative cuisine and service with exclusive catering
- Customized menus to please the most discriminating appetites

## Where the little things mean everything.™

At the DoubleTree by Hilton,™ we put the human touch back into your travel experience. It all starts with the warm welcome of a chocolate chip cookie at check-in. Then the caring keeps coming with everything from the luxurious comfort of our Sweet Dreams® sleep experience, to our highly-trained staff members who are dedicated to anticipating your needs so your stay is the best it can be. Come see us! We always have a cookie with your name on it ready and waiting.

#### ACCOMMODATIONS

DoubleTree by Hilton Bethesda – Washington DC has a variety of guest rooms that meet every need, from single business travelers to full families. You'll also enjoy the following accommodations in each of our rooms:

- 270 well-appointed guest rooms, including 9 extended stay residences
- Sweet Dreams® by DoubleTree sleep experience
- 42" Plasma HDTV
- Wireless high-speed internet access and remote guest room printing
- DIRECTV® Service and Premium television channels (HBO®, CNN®, ESPN®)
- Coffee or tea by celebrity chef Wolfgang Puck
- Sweet Dreams® alarm clock radio with MP3 connectivity
- Complimentary Wall Street Journal and USA Today®
- Two telephones, voicemail and data port
- CITRON Honey & Coriander by Crabtree & Evelyn® Bath Products

#### AT YOUR SERVICE

- Same-day laundry
- Valet parking
- 24-hour Business Center
- 24-hour Fitness by Precor® Gym
- Seasonal rooftop outdoor pool

#### DINING

No matter what you're hungry for, you'll find our kitchen is always open. Whether you're looking for breakfast, lunch, dinner, or ordering room service, you'll find we always have something fresh, tasty and healthy on the menu.

- *Share Small Plate Bistro* 6:30am - 2:00pm & 5:00pm - 11:00pm
- *The Cup* 6:30am - 2:00pm featuring Starbucks
- *Share Wine Lounge* 4:00pm - 11:00pm
- *In-room dining* 6:00am - 11:00pm



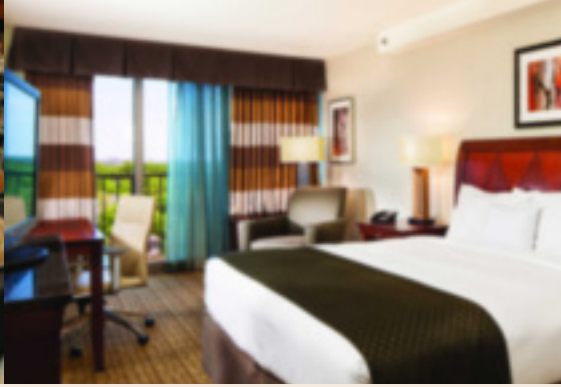

Name of Room	Total Sq. Ft.	Dimensions	Classroom	U-Shape	H-Square	Conference	Rounds	Theatre	Pods (6)	Pods (4)
Grand Ballroom	5658	41' x 138'	300	145	200	180	410	550	180	120
Grand Ballroom A	1271	41' x 31'	60	50	60	42	90	100	42	28
Grand Ballroom B	1312	41' x 32'	65	50	60	42	90	120	42	28
Grand Ballroom C	1640	41' x 40'	90	60	70	52	110	160	52	36
Grand Ballroom D	1435	41' x 35'	75	55	65	48	100	140	48	30
Harmony	1520	40' x 38'	60	24	28	20	100	75	42	36
Balance	720	36' x 20'	28	24	24	16	40	60	24	16
Wisdom	680	34' x 20'	28	24	24	16	40	60	24	16
Insight	640	32' x 20'	28	24	24	16	40	60	24	16
Gardenia	480	21' x 24'	18	14	16	12	30	45	18	12
Jasmine	720	36' x 20'	28	24	28	20	40	60	24	16
Juniper	720	36' x 20'	28	24	28	20	40	60	24	16
Lavender	720	36' x 20'	28	24	28	20	40	60	24	16
Lilac	720	36' x 20'	28	24	28	20	40	60	24	16
Orchid	646	34' x 19'	28	24	28	20	40	50	24	16

## 2ND LEVEL

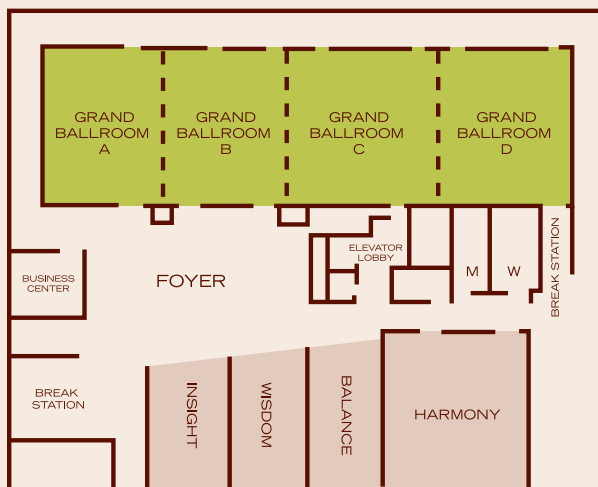

## 3RD LEVEL

